

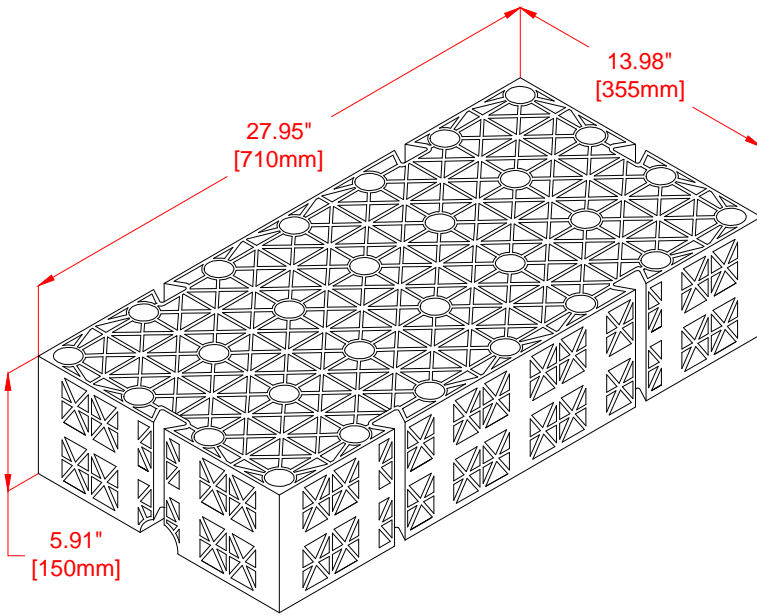

Permavoid 150 (PV150) structural cells are multi-functional water management solutions that promote sustainable stormwater behavior. The interconnected, high-strength units create a patented subbase replacement system that attenuates stormwater flows and, when feasible, promotes infiltration even beneath impervious surfaces. Units can be stacked to create multi-layer tanks to fit nearly any site constraints while eliminating the need for traditional conveyance schemes. Permavoid systems can also enhance landscape resiliency through patented capillary cylinders that wick stormwater up toward vegetation without the need for sprinklers, pumps or energy to create the ultimate low impact solution.



PHYSICAL PROPERTIES		
Material	Polypropylene	
Weight per unit	7.21 lbs	3.27 kg
Length	27.95 in	710 mm
Width	13.98 in	355 mm
Depth	5.91 in	150 mm
Area per unit	2.713 ft ²	0.252 m ²
Occupied volume per unit	1.335 ft ³	0.0378 m ³
STRUCTURAL PROPERTIES		
Vertical compressive yield	103.7 psi	715 kPa
Lateral compressive yield	22.6 psi	156 kPa
Vertical deflection strength	464 psi / in	126 kPa/mm
Lateral deflection strength	55.3 psi / in	15 kPa/mm
Tensile strength at single joint	6.15 psi	42.4 kPa
Bending resistance of unit	524 lb-ft	0.71 kN-m
Bending resistance of single joint	118 lb-ft	0.16 kN-m
Vertical creep limit (100 year)	24 psi	165 kPa
HYDRAULIC PROPERTIES		
Average perforated surface area	52 %	
Volumetric void ratio	95 %	
Void volume per unit	1.268 ft ³	0.0359 m ³
Conveyance at 0.0% Slope	74 GPM / ft ²	50.2 LPS / m ²
Conveyance at 1.0% Slope	119 GPM / ft ²	81.6 LPS / m ²
Conveyance at 2.0% Slope	139 GPM / ft ²	94.2 LPS / m ²
Conveyance at 3.0% Slope	157 GPM / ft ²	106.7 LPS / m ²
OTHER PROPERTIES		
Recycled content	100 %	
Recyclability	100 %	
Country of origin	United States of America	

ACCESSORIES

GEOTEXTILES

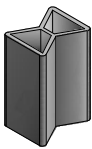

Tie Connector (PVTIE)
2x required per tie slot



Shear Connector (PVSC)
1x required per unit between layers (traffic)
1x required per 3 units between layers (non-traffic)



Capillary Irrigation Cone (2 pieces)
PVWC-35/42 + PVWC-27/113
2x required per unit

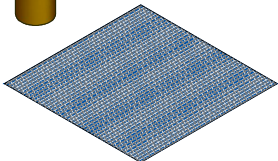

Capillary Geotextile (Permatex CAP HP)
Required for capillary irrigation applications
All sides wrapped with 12" [300mm] lap joints min.

The following are for guidance only. Refer to design documents for site specific requirements.

1. Non-woven fabric for separation and/or infiltration:
 - Tencate - Mirafi 1100N (or approved equal)
2. Woven fabric for separation and/or infiltration:
 - Tencate - Mirafi HP270 (or approved equal)
3. Waterproof Membrane Liner for retention and/or detention:
 - 40 mil HDPE or LLDPE (or approved equal)

Proprietary rights of ABT, Inc. are included in the information disclosed herein. The recipient, by accepting this document, agrees that neither this document nor the information disclosed herein nor any part thereof shall be copied, reproduced or transferred to others for manufacturing or for any other purpose except as specifically authorized in writing by ABT, Inc.
Disclaimer: The customer and the customer's architects, engineers, consultants and other professionals are completely responsible for the selection, installation, and maintenance of any product purchased from ABT, and EXCEPT AS EXPRESSLY PROVIDED IN ABT'S STANDARD WARRANTIES, ABT MAKES NO WARRANTY, EXPRESS OR IMPLIED, AS TO THE SUITABILITY, DESIGN, MERCHANTABILITY, OR FITNESS OF THE PRODUCT FOR CUSTOMER'S APPLICATION. Copies of ABT's standard warranties are available upon request.



P. O. Box 837
259 Murdock Road
Troutman, NC
(800) 438-6057
(704) 528-9806
www.ABTDRAINS.com