

PolyDrain[®]

Pre-Engineered Surface Drainage

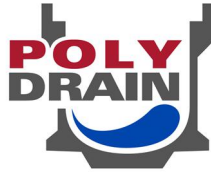

VectorDrain[™]

Installation Guide



P.O. Box 837 - 259 Murdock Road - Troutman, NC 28166
Tel (704) 528-9806 - Fax (704) 528-5478 - www.abtdrains.com
Toll free in the USA, Canada, and Mexico (800) 438-6057

[illegible]

ITEM
1
2
3
4

Some products sold by ABT contain chemicals known to the State of California to cause cancer, birth defects or other reproductive harm. Products sold by ABT may contain these chemicals in a smaller amount than Proposition 65's concern, or not at all, however, we have chosen to issue this warning on all of our products as an act of caution and because our customers have the right to know.

! WARNING: These products can expose you to chemicals such as nickel, lead, chromium, cobalt, styrene, methylene chloride, or silica, which are known to the State of California to cause cancer and birth defects or other reproductive harm. For more information go to www.P65Warnings.ca.gov.

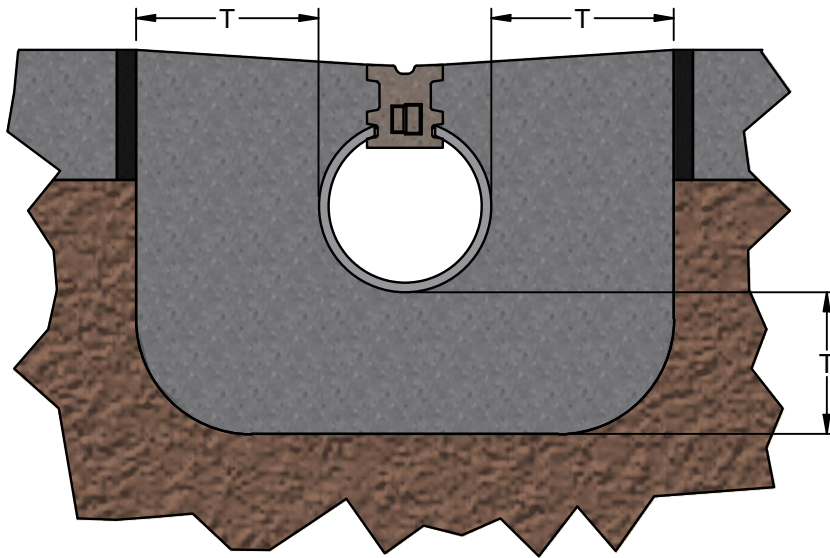

1. EXCAVATION

T = Per Structural Engineer

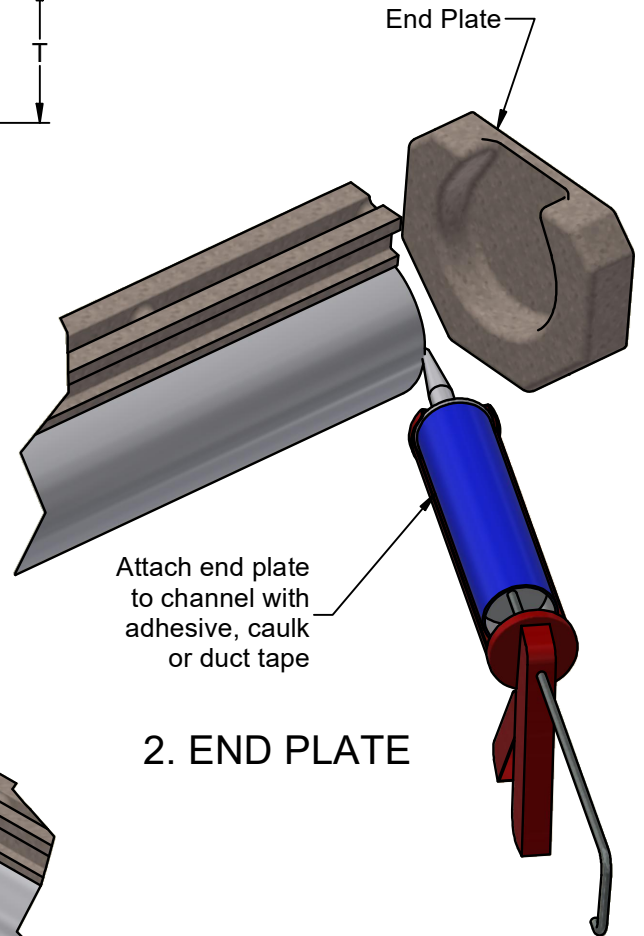

Attach end plate
to channel with
adhesive, caulk
or duct tape

2. END PLATE

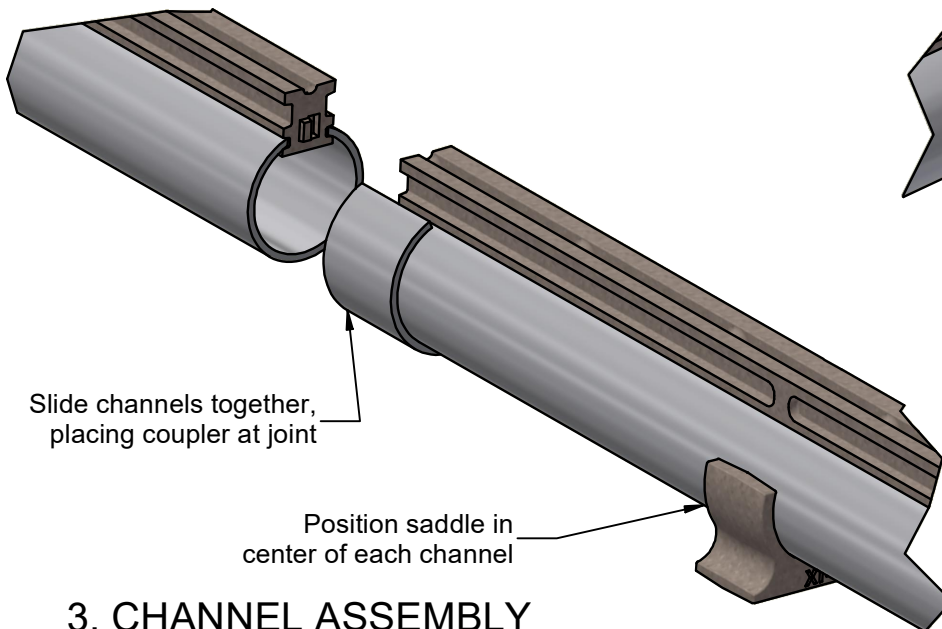

Slide channels together,
placing coupler at joint

Position saddle in
center of each channel

3. CHANNEL ASSEMBLY

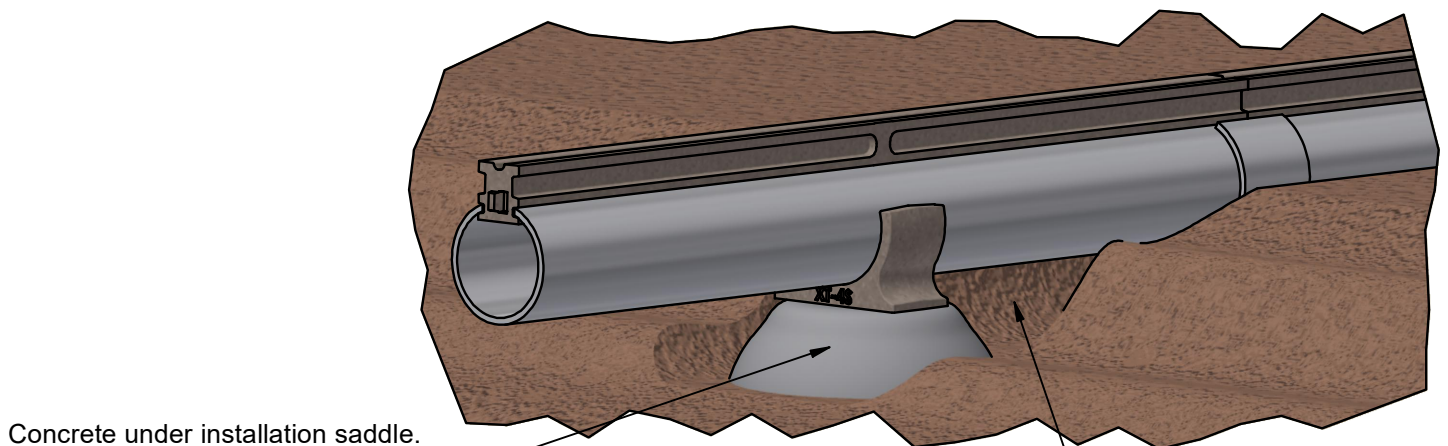

Concrete under installation saddle.
Caution: Avoid cold joints.
Base less than 8" diameter

Leave open for
monolithic pour

4. CHANNEL PLACEMENT

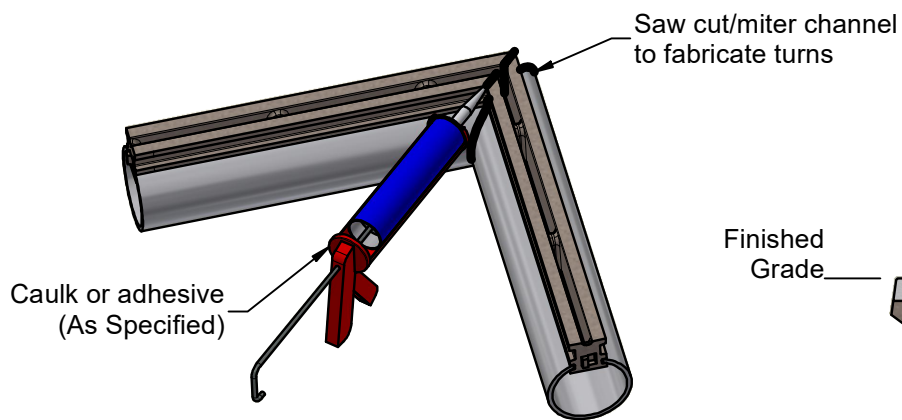

5. CORNER FABRICATION

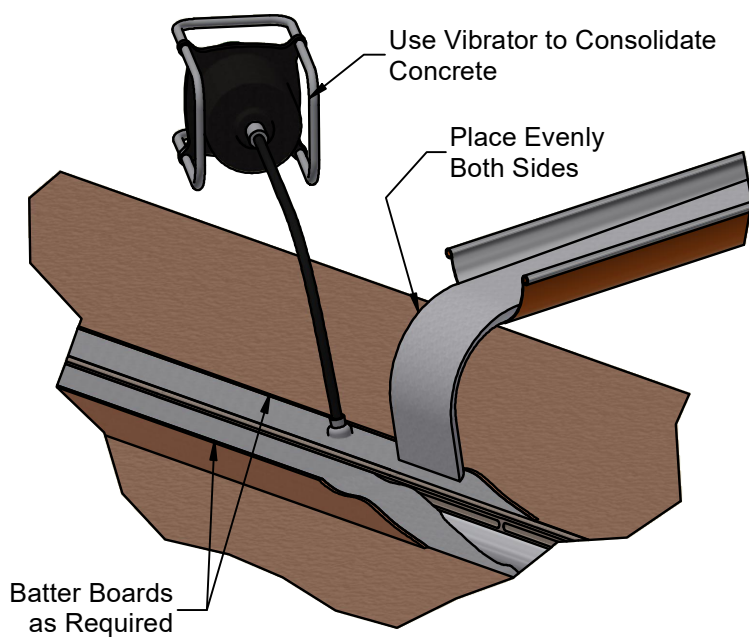

7. ENCAPSULATION CONCRETE PLACEMENT & CONSOLIDATION

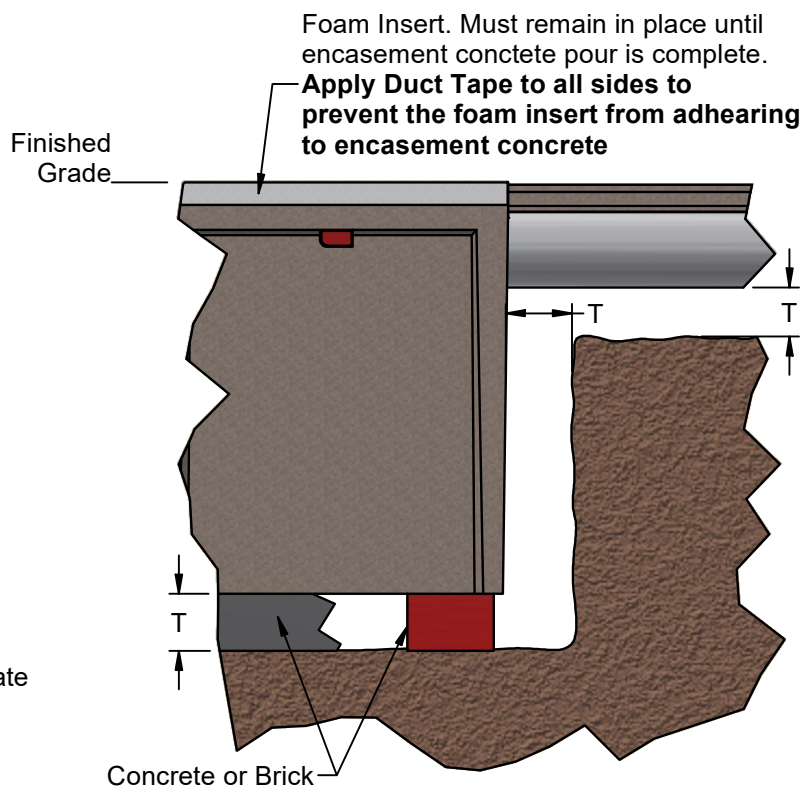

6. CATCH BASIN INSTALLATION

T = Per Structural Engineer

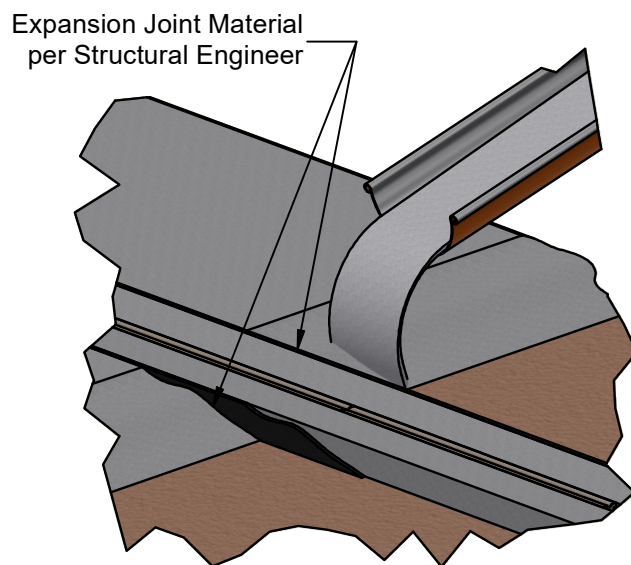

8. FLOOR CONCRETE PLACEMENT

